

TO: James L. App, City Manager

FROM: Ron Whisenand, Community Development Director

SUBJECT: Mitigated Negative Declaration for Templeton Interceptor Upgrade and Reclaimed Water Line in River Road

DATE: October 2, 2007

Needs: For the City Council to consider approval of a Mitigated Negative Declaration for the Templeton Interceptor Upgrade and Reclaimed Water Line in River Road

- Facts:
1. Pursuant to the 2007 Sewer Collection System Master Plan, 2007 Integrated Water Resources Plan, and the 2003 General Plan, the City has initiated the work described below to consist of the following components:
 - A. Upgrade the existing Templeton Interceptor sewer main in River Road in two reaches (sections) from 21 and 24 inch VCP pipe to 27 to 30 inch VCP or PVC pipe. The two reaches are as follows:
 - Reach 1: Beginning at Lift Station #1, which is located approximately 1,600 feet north of River Oaks Drive, extending south to Union Road;
 - Reach 2: Beginning at a point approximately 400 feet south of Creston Road, extending south to Navajo Avenue.
 - B. Install a reclaimed water line in River Road between Lift Station #1 on the north and the Highway 46E overpass on the south.
 2. The City has already completed upgrading of the Templeton Interceptor between Navajo Avenue and Templeton, and beneath Creston Road. The reaches described above are the only remaining segments in need of upgrading.
 3. The project consists of installing pipeline beneath the pavement of River Road. No undeveloped land will be affected by the project.
 4. This project will be carried out in conjunction with the Nacimiento Water Project (NWP). The San Luis Obispo County Flood Control and Water Conservation District, which is the entity constructing the NWP, has granted the City approval for a contract change order for construction of the Templeton Sewer Upgrade and Reclaimed Water Pipeline simultaneously with construction of the NWP.
 5. Attached is an Initial Study, which concludes that, subject to the implementation of a single mitigation measure to require the contractor to prepare and implement a sewer “bypass pumping plan”, the project will not have any significant effects on the environment, and proposes that a Mitigated Negative Declaration be approved.
 6. Public notice of the proposed Mitigated Negative Declaration was given as required by Section 21092 of the Public Resources Code. Pursuant to said public notice, the public was given the opportunity to submit written comments and to appear before the City

Council at a public meeting conducted on October 2, 2007 to make oral comments on the draft Mitigated Negative Declaration.

Analysis and
Conclusion:

An Environmental Impact Report (EIR) was prepared for the NWP. The contract for the NWP Project includes mitigation measures pertinent to the construction of the water pipeline. As a change order to the NWP Contract, the Templeton Interceptor upgrade and Reclaimed Water Line Project would be subject to the same mitigation measures, which would cover the full range of impacts associated with trenching and laying pipes in River Road.

The attached Initial Study notes that one potentially significant impact that would not have been addressed with the NWP project is prevention of sewage leaks and mitigation of any sewage leaks that might occur during sewer bypass operations.

A mitigating condition incorporated into prior phases of the Templeton Interceptor Upgrade was a “bypass pumping plan” to prevent sewage leaks and respond to, contain, and clean up any leaks that might occur in relation to the bypass operation. The requirements for such a plan are presently being prepared by the City’s design engineer for inclusion in the contract documents. The draft specifications are detailed and comprehensive. They include such measures as:

- Requiring that the bypass be attended and monitored by qualified personnel continuously (24 hours a day, seven days a week);
- The personnel monitoring the pump shall be equipped with a cellular telephone so that additional personnel can be contacted in case of an emergency;
- The Contractor shall have onsite a fully functional and fueled standby pump(s) that can be placed in service if the primary pumping unit malfunctions.

Policy

Reference: California Environmental Quality Act

Fiscal

Impact: The Mitigated Negative Declaration will have no effect on the General Fund.

Options:

Upon receipt of public comments, take one of the following actions:

- a. Adopt the attached Resolution 07-XXX approving a Mitigated Negative Declaration for the Project.
- b. Amend, modify, or reject the foregoing option.

Report prepared by: Ed Gallagher, City Planner

Attachments:

1. Resolution Approving a Mitigated Negative Declaration
2. Initial Study and Project Map
3. Mitigation Monitoring Plan
4. Newspaper Notice of Negative Declaration

ED\ENV\TEMPLETON INTERCEPTOR\ 2007\CCR 100207

RESOLUTION NO: 07-XXX

**A RESOLUTION OF THE CITY COUNCIL OF THE CITY OF PASO ROBLES
ADOPTING A MITIGATED NEGATIVE DECLARATION FOR THE TEMPLETON
INTERCEPTOR UPGRADE AND RECLAIMED WATER LINE IN RIVER ROAD**

WHEREAS, pursuant to the 2007 Sewer Collection System Master Plan, 2007 Integrated Water Resources Plan, and the 2003 General Plan, the City of El Paso de Robles (the “City”) has initiated the work described below (the “Project”) to consist of the following components:

- A. Upgrade the existing Templeton Interceptor sewer main in River Road in two reaches (sections) from 21 and 24 inch VCP pipe to 27 to 30 inch VCP or PVC pipe. The two reaches are as follows:
 - Reach 1: Beginning at Lift Station #1, which is located approximately 1,600 feet north of River Oaks Drive, extending south to Union Road;
 - Reach 2: Beginning at a point approximately 400 feet south of Creston Road, extending south to Navajo Avenue.
- B. Install a reclaimed water line in River Road between Lift Station #1 on the north and the Highway 46E overpass on the south.

WHEREAS, an Initial Study, attached as Exhibit A to this resolution, was prepared for this project, and it identifies the impact described below as having the potential for significant impacts as a result of this project

Hazards: Prevention of sewage leaks and mitigation of any sewage leaks that might occur during sewer bypass operations; and

WHEREAS, the potentially significant environmental impact related to Hazards can be mitigated by the City ensuring , via contract specifications, that the contractor prepare and implement a “bypass pumping plan” to prevent sewage leaks, and respond to, contain, and clean up any leaks that might occur in relation to the bypass operation; and

WHEREAS, a Mitigation Monitoring Plan, listing the “bypass pumping plan” mitigation measure is attached as Exhibit “B”; and

WHEREAS, Public Notice of the proposed Negative Declaration was given as required by Section 21092 of the Public Resources Code; and pursuant to said public notice, the public was given the opportunity to submit written comments and to appear before the City Council at a public meeting conducted on October 2, 2007 to make oral comments on the draft Negative Declaration; and

WHEREAS, based on the information contained in the Initial Study prepared for this project and testimony received as a result of the public notice, and subject to implementation of the mitigation measure listed in Exhibit “A”, the City Council finds no substantial evidence that the project would have a significant impact on the environment;

NOW, THEREFORE, BE IT RESOLVED AS FOLLOWS:

SECTION 1. Based on the information contained in the plans and specifications prepared for the Project on file with the City's Department of Public Works, the Initial Study prepared for the Project, public comments and testimony received during the comment period and at the public meeting conducted on October 2, 2007, and subject to completion of the mitigation measure described in both Exhibits "A" and "B", the City Council finds, based on its independent judgment and analysis, that there is no substantial evidence that the Project will have a significant effect on the environment.

SECTION 2. The City Council of the City of Paso Robles does hereby approve and adopt the Mitigated Negative Declaration for the Project. All of the documents and other evidence which constitute the record of proceedings upon which the findings in this Resolution are made are in the custody of the Department of Public Works, City Hall, 1000 Spring Street, Paso Robles, California 93446.

SECTION 3. The City Council of the City of Paso Robles does hereby approve the Project, and directs the City Clerk to file a Notice of Determination regarding the approval of the Project with the County Clerk of San Luis Obispo County for posting.

PASSED AND ADOPTED this 2nd day of October, 2007, by the following roll call vote:

AYES:

NOES:

ABSENT:

ABSTAIN:

Frank R. Mecham, Mayor

ATTEST:

Deborah D. Robinson, Deputy City Clerk

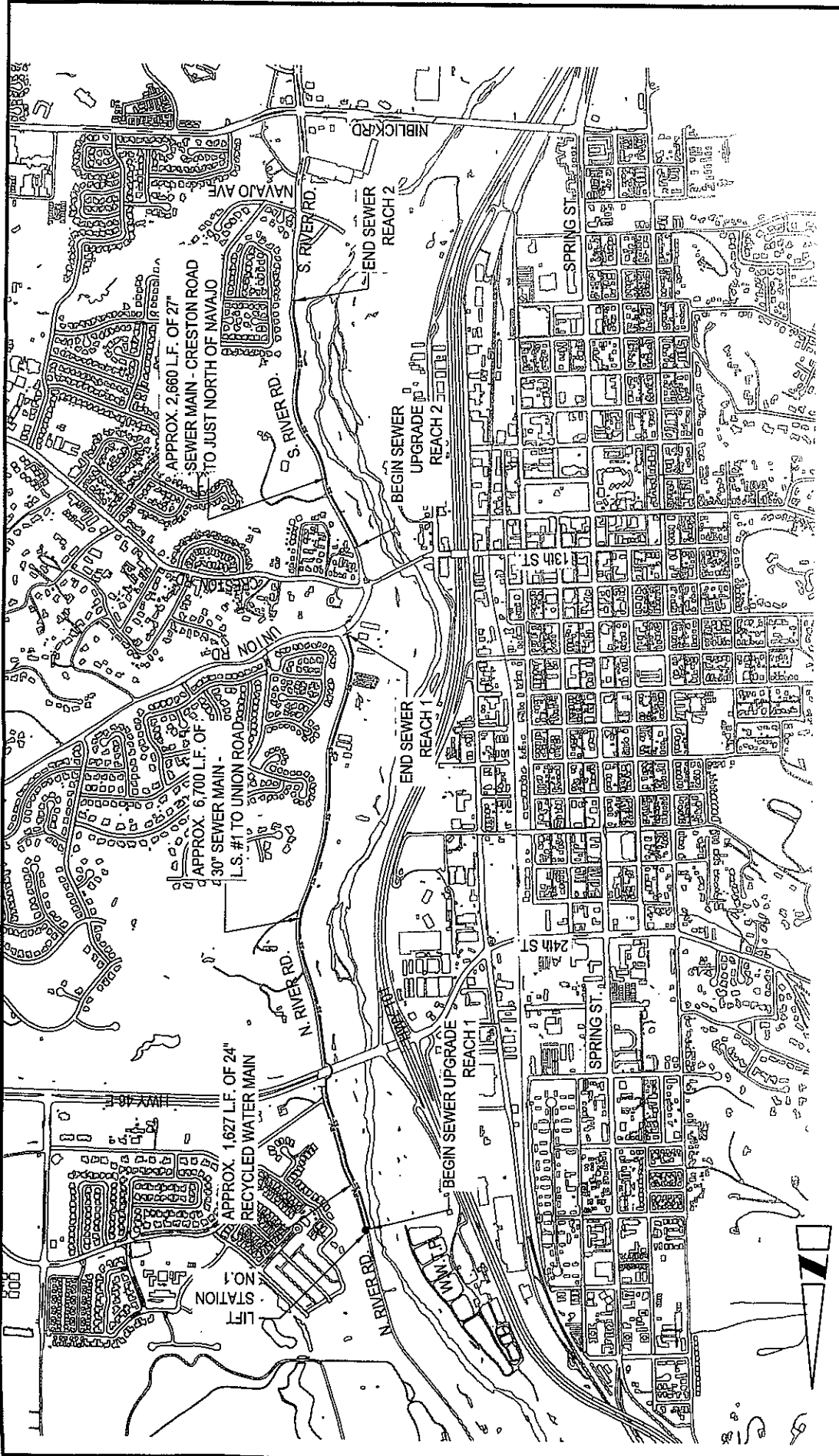

BOYLE
 CIVIL ENGINEERING
 1141 North Main Street
 San Luis Obispo, CA 93401
 Tel: 805-342-8999
 WWW.BOYLEENGINEERING.COM

RIVER ROAD SEWER AND RECYCLED WATER PIPELINES
 PROPOSED PIPELINE ALIGNMENTS

BEC PROJECT NO. 20000.16

FIGURE 1



DWG: W Post Roads (20000.X) (20000.16) River Rd Sewer Main/CAD Design Figure 1.dwg
 DATE: Jun 18, 2007 2:39pm
 XREFS: Pipelines-REV
 IACCS:
 USERS: jfeather

Exhibit A

CITY OF PASO ROBLES
INITIAL STUDY

1. GENERAL PROJECT INFORMATION

PROJECT TITLE: Templeton Interceptor Sewer Upgrade and Reclaimed Water Line in River Road

LEAD AGENCY: City of Paso Robles, 1000 Spring Street, Paso Robles, CA 93446

Initial Study Contact: Ed Gallagher, City Planner
Phone/email: (805) 237-3970, ed@prcity.com

PROJECT LOCATION: River Road in the following reaches (segments)

- a. Reach 1: Between Lift Station #1, approximately 1,600 feet north of River Oaks Drive and Union Road
- b. Reach 2: Between Navajo Avenue and a point approximately 400 feet south of Creston Road

(See attached location map.)

PROJECT PROPONENT: City of Paso Robles

Project Contact Person: Ditas Esperanza, Capital Projects Engineer
Phone/email: (805) 237-3860, ditas@prcity.com

GENERAL PLAN DESIGNATION: Not applicable (sewer main and reclaimed water line will be installed within a roadway that crosses several land use categories)

ZONING: Not applicable (sewer main and reclaimed water line will be installed within a roadway that crosses several zoning districts)

2. **PROJECT DESCRIPTION:**

A. Upgrade the existing Templeton Interceptor sewer main in River Road in two reaches (sections) from 21 and 24 inch VCP pipe to 27 to 30 inch VCP or PVC pipe. This upgrade was originally recommended by the City's Sewer Master Plan (SMP), adopted in 1993, pursuant to the 1991 General Plan Update. The 2007 Sewer Collection System Master Plan, adopted pursuant to the 2003 General Plan Update, also identifies the need for this upgrade. Other reaches of the Templeton Interceptor have already been upgraded in accordance with the SMP.

The two reaches are as follows (and as shown on the attached map):

Reach 1: Beginning at Lift Station #1, which is located approximately 1,600 feet north of River Oaks Drive, extending south to Union Road;

Reach 2: Beginning at a point approximately 400 feet south of Creston Road, extending south to Navajo Avenue.

- B. Install a reclaimed water line in River Road between Lift Station #1 on the north and the Highway 46E overpass on the south. This improvement is listed in the 2007 Integrated Water Resources Plan as a component of a reclaimed water system to be developed over several years. It is anticipated that the primary users will be existing and planned golf courses, and that the main line will eventually follow the Highway 46E right-of-way. This component was scheduled to be completed concurrently with the upgrading of the Templeton Interceptor and the takes advantage of the construction of the Nacimiento Water Project (NWP) pipeline in River Road in order to minimize excavation in River Road.

The Templeton Interceptor Upgrade is a multi-phased project, which began construction in 2002. All other phases have been completed, only Reaches #1 and 2 remain to be completed. The method of construction for Reaches #1 and 2 will entail: constructing a surface temporary bypass sewer line (which will run along the edge of pavement of River Road), opening a trench in River Road, removing the existing main, installing the new, larger main, backfilling the trench, and repaving River Road.

The Reclaimed Water Line will also be installed in a separate trench in River Road. It will be capped at both ends for future use, when funding will become available for a wastewater treatment system and extension of the line to the east.

The two components are proposed to be added to the contract to construct the NWP, which will also be installed in River Road, as a change order. Each component and the NWP will be laid in separate trenches in River Road, beneath existing paving. None of the pipes/trenches will be cross undeveloped land. Installation of the Templeton Interceptor and Reclaimed Water Line will occur simultaneously with installation of the NWP. That is, River Road will be "opened" for trenching and closed to traffic one time. As of August 24, 2007, the lowest responsive bid for the NWP has been identified, but the contract has not yet been approved and a schedule of operations has not yet been published.

3. ENVIRONMENTAL SETTING:

The Environmental Impact Report (EIR) for the 2003 General Plan Update describes the environmental setting for the City's General Plan, including those projects, such as this one, that are designed to implement the General Plan. Additionally, as will be noted in Item #10, below, an EIR was prepared for the NWP Project, and the environmental setting for that EIR accurately describes the environmental setting for this project.

4. OTHER AGENCIES WHOSE APPROVAL IS REQUIRED (AND PERMITS NEEDED):

The San Luis Obispo County Flood Control and Water Conservation District, which is the entity constructing the NWP, has granted the City approval of construction of the Templeton Sewer Upgrade and Reclaimed Water Pipeline simultaneously with construction of the NWP.

5. RELATED ENVIRONMENTAL DOCUMENTATION: none

An Environmental Impact Report (EIR) was prepared for the NWP Project. This EIR is available for reading on line at <http://www.slocounty.ca.gov/PW/NacWP/reports/EIRFinal.htm>.) The contract for the NWP Project includes mitigation measures pertinent to the construction of the water pipeline. As a change order to the NWP Contract, the Templeton Interceptor upgrade and Reclaimed Water Line Project would be subject to the same mitigation measures, which would cover the full range of impacts associated with trenching and laying pipes in River Road.

The environmental checklist below indicates that there will be no impacts to water, air quality, biological resources, and transportation because mitigation measures for those impacts were identified for the NWP EIR

and are conditions of contract documents for that project. The Templeton Interceptor Upgrade and Reclaimed Water Project will be a change order to that project, and therefore, subject to the same mitigation measures.

One potentially significant impact that would not have been addressed with the NWP project is prevention of sewage leaks and mitigation of any sewage leaks that might occur during sewer bypass operations.

A mitigating condition incorporated into prior phases of the Templeton Interceptor Upgrade was a “bypass pumping plan” to prevent sewage leaks and respond to, contain, and clean up any leaks that might occur in relation to the bypass operation. The requirements for such a plan are presently being prepared by the City’s design engineer for inclusion in the contract documents. The draft specifications are detailed and comprehensive. They include such measures as:

- Requiring that the bypass be attended and monitored by qualified personnel continuously (24 hours a day, seven days a week);
- The personnel monitoring the pump shall be equipped with a cellular telephone so that additional personnel can be contacted in case of an emergency;
- The Contractor shall have onsite a fully functional and fueled standby pump(s) that can be placed in service if the primary pumping unit malfunctions.

6. CONTEXT OF ENVIRONMENTAL ANALYSIS FOR PROJECT:

This Initial Study focuses on the environmental effects associated with adding the construction of an upgraded sewer line and a reclaimed water line in River Road.

The need for a sewer upgrade is documented in the 2007 Sewer Collection System Master Plan, adopted pursuant to the 2003 General Plan Update. The need for a reclaimed water line is documented in the Integrated Water Resources Plan, adopted in May 2007, also pursuant to the 2003 General Plan Update.

The Project is being undertaken in accordance with these plans and does not create a growth-inducing effect.

7. PURPOSES OF AN INITIAL STUDY

The purposes of an Initial Study for a Development Project Application are:

- A. To provide the City with sufficient information and analysis to use as the basis for deciding whether to prepare an Environmental Impact Report, a Mitigated Negative Declaration, or a Negative Declaration for a site specific development project proposal;
- B. To enable the Applicant of a site specific development project proposal or the City as the lead agency to modify a project, mitigating adverse impacts before an Environmental Impact Report is required to be prepared, thereby enabling the proposed Project to qualify for issuance of a Negative Declaration or a Mitigated Negative Declaration;
- C. To facilitate environmental assessment early in the design of a project;
- D. To eliminate unnecessary EIRs;
- E. To explain the reasons for determining that potentially significant effects would not be significant;
- F. To determine if a previously prepared EIR could be used for the project;
- G. To assist in the preparation of an Environmental Impact Report if one is required; and

- H. To provide documentation of the factual basis for the finding of no significant effect as set forth in a Negative Declaration or a Mitigated Negative Declaration prepared for the a project.

8. EXPLANATION OF ANSWERS FOUND ON THE ENVIRONMENTAL CHECKLIST FORM

A. Scope of Environmental Review

This Initial Study evaluates potential impacts identified in the following checklist.

B. Evaluation of Environmental Impacts

1. A brief explanation is required for all answers to the questions presented on the following Environmental Checklist Form, except where the answer is that the proposed project will have “No Impact.” The “No Impact” answers are to be adequately supported by the information sources cited in the parentheses following each question or as otherwise explained in the introductory remarks. A “No Impact” answer is adequately supported if the referenced information sources show that the impact simply does not apply to the project. A “No Impact” answer should be explained where it is based on project-specific factors and/or general standards. The basis for the “No Impact” answers on the following Environmental Checklist Form is explained in further detail in this Initial Study in Section 9 (Earlier Environmental Analysis and Related Environmental Documentation) and Section 10 (Context of Environmental Analysis for the Project).
2. All answers on the following Environmental Checklist Form must take into account the whole action involved with the project, including implementation. Answers should address off-site as well as on-site, cumulative as well as project-level, indirect as well as direct, and construction as well as operational impacts.
3. “Potentially Significant Impact” is appropriate, if an effect is significant or potentially significant, or if the lead agency lacks information to make a finding of insignificance. If there are one or more “Potentially Significant Impact” entries when the determination is made, preparation of an Environmental Impact Report is warranted.
4. “Potentially Significant Impact Unless Mitigated” applies where the incorporation of mitigation measures has reduced an effect from “Potentially Significant Impact” to a “Less than Significant Impact.” The lead agency must describe the mitigation measures, and briefly explain how they reduce the effect to a less than significant level. Mitigation Measures from Section 9 (Earlier Environmental Analysis and Related Environmental Documentation) may be cross-referenced).
5. Earlier analyses may be used where, pursuant to the tiering, program EIR, or other CEQA process, an effect has been adequately analyzed in an earlier EIR or negative declaration. Section 15063(c)(3)(D). See Section 4 (Earlier Environmental Analysis and Related Environmental Documentation) and Section 11 (Earlier Analysis and Background Materials) of this Initial Study.
6. References to the information sources for potential impacts (e.g., general plans, zoning ordinances) have been incorporated into the Environmental Checklist Form. See Section 11 (Earlier Analysis and Related Environmental Documentation). Other sources used or individuals contacted are cited where appropriate.
7. The following Environmental Checklist Form generally is the same as the one contained in Title 14, California Code of Regulations; with some modifications to reflect the City’s needs and requirements.
8. Standard Conditions of Approval: The City imposes standard conditions of approval on Projects. These conditions are considered to be components of and/or modifications to the Project and some reduce or minimize environmental impacts to a level of insignificance. Because they are considered part of the

Project, they have not been identified as mitigation measures. For the readers' information, the standard conditions identified in this Initial Study are available for review at the Community Development Department.

9. Certification Statement: The statements made in this Initial Study and those made in the documents referenced herein present the data and information that are required to satisfy the provisions of the California Environmental Quality Act (CEQA) – Statutes and Guidelines, as well as the City's Procedures for Implementing CEQA. Further, the facts, statements, information, and analysis presented are true and correct in accordance with standard business practices of qualified professionals with expertise in the development review process, including building, planning, and engineering.

ENVIRONMENTAL FACTORS POTENTIALLY AFFECTED:

The environmental factors checked below would be potentially affected by this project, involving at least one impact that is a "Potentially Significant Impact" or is "Potentially Significant Unless Mitigated," as indicated by the checklist on the following pages.

- | | | |
|---|---|--|
| <input type="checkbox"/> Land Use & Planning | <input type="checkbox"/> Transportation/Circulation | <input type="checkbox"/> Public Services |
| <input type="checkbox"/> Population & Housing | <input type="checkbox"/> Biological Resources | <input type="checkbox"/> Utilities & Service Systems |
| <input type="checkbox"/> Geological Problems | <input type="checkbox"/> Energy & Mineral Resources | <input type="checkbox"/> Aesthetics |
| <input type="checkbox"/> Water | <input checked="" type="checkbox"/> Hazards | <input type="checkbox"/> Cultural Resources |
| <input type="checkbox"/> Air Quality | <input type="checkbox"/> Noise | <input type="checkbox"/> Recreation |
| | <input type="checkbox"/> Mandatory Findings of Significance | |

DETERMINATION

(To be completed by the Lead Agency)

On the basis of this initial evaluation:

I find that the proposed project **COULD NOT** have a significant effect on the environment, and a **NEGATIVE DECLARATION** will be prepared.

I find that although the proposed project could have a significant effect on the environment, there will not be a significant effect in this case because the mitigation measures described on an attached sheet have been added to the project. **A NEGATIVE DECLARATION** will be prepared.

I find that the proposed project **MAY** have a significant effect on the environment, and an **ENVIRONMENTAL IMPACT REPORT** is required.

I find that the proposed project **MAY** have a significant effect(s) on the environment, but one or more effects (1) have been adequately analyzed in an earlier document pursuant to applicable legal standards, and (2) have been addressed by mitigation measures based on the earlier analysis as described on attached sheets, if the effect is a “potentially significant impact” or is “potentially significant unless mitigated.” An **ENVIRONMENTAL IMPACT REPORT** is required, but it must analyze only the effect(s) that remain to be addressed.

I find that although the proposed project could have a significant effect(s) on the environment, there **WILL NOT** be a significant effect in this case because all potentially significant effects (a) have been analyzed adequately in an earlier EIR pursuant to applicable standards, and (b) have been avoided or mitigated pursuant to that earlier EIR, including revisions or mitigation measures that are imposed upon the proposed project. (See item #11 above, for a specific reference to that EIR.)

Signature

Ed Gallagher

Printed Name

09/07/07

Date

City Planner

Title

EVALUATION OF ENVIRONMENTAL IMPACTS:

1. A brief explanation is required for all answers except “No Impact” answers that are adequately supported by the information sources a lead agency cites in the parentheses following each question. A “No Impact” answer is adequately supported if the referenced information sources show that the impact simply does not apply to the project. A “No Impact” answer should be explained where it is based on project-specific factors as well as general standards.
2. All answers must take account of the whole action involved. Answers should address off-site as well as on-site, cumulative as well as project-level, indirect as well as direct, and construction as well as operational impacts.
3. “Potentially Significant Impact” is appropriate, if an effect is significant or potentially significant, or if the lead agency lacks information to make a finding of insignificance. If there are one or more “Potentially Significant Impact” entries when the determination is made, preparation of an Environmental Impact Report is warranted.
4. “Potentially Significant Impact Unless Mitigated” applies where the incorporation of mitigation measures has reduced an effect from “Potentially Significant Impact” to a “Less than Significant Impact.” The lead agency must describe the mitigation measures, and briefly explain how they reduce the effect to a less than significant level (mitigation measures from Section XVII, “Earlier Analyses,” may be cross-referenced).
5. Earlier analyses may be used where, pursuant to the tiering, program EIR, or other CEQA process, an effect has been adequately analyzed in an earlier EIR or negative declaration. Section 15063(c)(3)(D). Earlier analyses are discussed in Section XVII at the end of the checklist.
6. References to information sources for potential impacts (e.g., general plans, zoning ordinances) have been incorporated into the checklist. A source list has been provided at the end of the checklist. Other sources used or individuals contacted have been cited in the respective discussions.
7. The following checklist has been formatted after Appendix I of Chapter 3, Title 14, California Code of Regulations, but has been augmented to reflect the needs and requirements of the City of Paso Robles.

(Note: Standard Conditions of Approval - The City imposes standard conditions of approval on projects which are considered to be components of or modifications to the project, some of these standard conditions also result in reducing or minimizing environmental impacts to a level of insignificance. However, because they are considered part of the project, they have not been identified as mitigation measures. For the readers’ information, a list of applicable standard conditions identified in the discussions has been provided as an attachment to this document.)_

SAMPLE QUESTION:

<i>ISSUES (and Supporting Information Sources):</i>	<i>Potentially Significant Impact</i>	<i>Potentially Significant Unless Mitigation Incorporated</i>	<i>Potentially Significant Unless Mitigation Incorporated</i>	<i>Less Than Significant Impact</i>	<i>No Impact</i>
<p><i>Would the proposal result in or expose people to potential impacts involving:</i></p> <p><i>Landslides or Mud flows? (Sources: 1, 6)</i></p> <p><i>Discussion: The attached source list explains that 1 is the Paso Robles General Plan and 6 is a topographical map of the area which show that the area is located in a flat area. (Note: This response probably would not require further explanation).</i></p>	<input type="checkbox"/>	<input type="checkbox"/>	<input type="checkbox"/>	<input type="checkbox"/>	<input checked="" type="checkbox"/>

ISSUES (and Supporting Information Sources):	Potentially Significant Impact	Potentially Significant Unless Mitigation Incorporated	Less Than Significant Impact	No Impact
--	--------------------------------------	--	------------------------------------	-----------

I. LAND USE AND PLANNING. Would the Proposal:

- | | | | | |
|---|--------------------------|--------------------------|--------------------------|-------------------------------------|
| a) Conflict with general plan designation or zoning? (Source: Paso Robles Zoning Code.) | <input type="checkbox"/> | <input type="checkbox"/> | <input type="checkbox"/> | <input checked="" type="checkbox"/> |
|---|--------------------------|--------------------------|--------------------------|-------------------------------------|

Discussion: The project is identified by the 2007 Sewer Collection System Master Plan and the 2007 Integrated Water Resources Plan as a necessary measure to implement the 2003 General Plan Update.

- | | | | | |
|---|--------------------------|--------------------------|--------------------------|-------------------------------------|
| b) Conflict with applicable environmental plans or policies adopted by agencies with jurisdiction over the project? | <input type="checkbox"/> | <input type="checkbox"/> | <input type="checkbox"/> | <input checked="" type="checkbox"/> |
|---|--------------------------|--------------------------|--------------------------|-------------------------------------|

Discussion: See response to Item #I.a, above.

- | | | | | |
|--|--------------------------|--------------------------|--------------------------|-------------------------------------|
| c) Be incompatible with existing land use in the vicinity? | <input type="checkbox"/> | <input type="checkbox"/> | <input type="checkbox"/> | <input checked="" type="checkbox"/> |
|--|--------------------------|--------------------------|--------------------------|-------------------------------------|

Discussion: Once the project is complete and the excavations filled and repaved, the sewer main and reclaimed water line will not be visible.

- | | | | | |
|--|--------------------------|--------------------------|--------------------------|-------------------------------------|
| d) Affect agricultural resources or operations (e.g., impacts to soils or farmlands, or impacts from incompatible uses)? | <input type="checkbox"/> | <input type="checkbox"/> | <input type="checkbox"/> | <input checked="" type="checkbox"/> |
|--|--------------------------|--------------------------|--------------------------|-------------------------------------|

Discussion:

- | | | | | |
|---|--------------------------|--------------------------|--------------------------|-------------------------------------|
| e) Disrupt or divide the physical arrangement of an established community (including a low-income or minority community)? | <input type="checkbox"/> | <input type="checkbox"/> | <input type="checkbox"/> | <input checked="" type="checkbox"/> |
|---|--------------------------|--------------------------|--------------------------|-------------------------------------|

Discussion: Not applicable to this project.

II. POPULATION AND HOUSING. Would the proposal:

- | | | | | |
|---|--------------------------|--------------------------|--------------------------|-------------------------------------|
| a) Cumulatively exceed official regional or local population projections? | <input type="checkbox"/> | <input type="checkbox"/> | <input type="checkbox"/> | <input checked="" type="checkbox"/> |
|---|--------------------------|--------------------------|--------------------------|-------------------------------------|

Discussion: The increased size of the sewer main is necessary to accommodate the growth provided for in the 2003 General Plan Update and to honor the City's agreement to provide an average of 400,000 GPD waste water treatment to Templeton.

- | | | | | |
|---|--------------------------|--------------------------|--------------------------|-------------------------------------|
| b) Induce substantial growth in an area either directly or indirectly (e.g., through projects in an undeveloped area or extension of major infrastructure)? | <input type="checkbox"/> | <input type="checkbox"/> | <input type="checkbox"/> | <input checked="" type="checkbox"/> |
|---|--------------------------|--------------------------|--------------------------|-------------------------------------|

Discussion: See response to Item #I.a, above.

- | | | | | |
|--|--------------------------|--------------------------|--------------------------|-------------------------------------|
| c) Displace existing housing, especially affordable housing? | <input type="checkbox"/> | <input type="checkbox"/> | <input type="checkbox"/> | <input checked="" type="checkbox"/> |
|--|--------------------------|--------------------------|--------------------------|-------------------------------------|

Discussion: Not applicable to this project.

III. GEOLOGIC PROBLEMS. Would the proposal result in or expose people to potential impacts involving:

ISSUES (and Supporting Information Sources):	Potentially Significant Impact	Potentially Significant Unless Mitigation Incorporated	Less Than Significant Impact	No Impact
a) Fault rupture? Discussion: The project consists of replacing an existing sewer main that is operating near capacity. The portions of the main being replaced do not traverse any known faults.	<input type="checkbox"/>	<input type="checkbox"/>	<input type="checkbox"/>	<input checked="" type="checkbox"/>
b) Seismic ground shaking? Discussion: See the response to Item IIIa.	<input type="checkbox"/>	<input type="checkbox"/>	<input type="checkbox"/>	<input checked="" type="checkbox"/>
c) Seismic ground failure, including liquefaction? Discussion: The City's General Plan contains public safety policies that would require special attention to projects with potential for liquefaction. Also, see the response to Item IIIa. Based on the above discussion, the potential for exposure of persons or property to seismic hazards, including liquefaction is not considered significant.	<input type="checkbox"/>	<input type="checkbox"/>	<input type="checkbox"/>	<input checked="" type="checkbox"/>
d) Seiche, tsunami, or volcanic hazard? Discussion: The project site is not located in an area identified at risk for seiche, tsunami, or volcanic hazards.	<input type="checkbox"/>	<input type="checkbox"/>	<input type="checkbox"/>	<input checked="" type="checkbox"/>
e) Landslides or Mud flows? Discussion: The sewer main would not be affected by, or contribute to, landslides and mudflows.	<input type="checkbox"/>	<input type="checkbox"/>	<input type="checkbox"/>	<input checked="" type="checkbox"/>
f) Erosion, changes in topography or unstable soil conditions from excavation, grading, or fill? Discussion: The Project involves replacing/constructing sewer and reclaimed water in mains beneath the paved surface of an existing road. The excavations will be re-filled, compacted, and repaved as necessary to restore the road surface to its pre-project state.	<input type="checkbox"/>	<input type="checkbox"/>	<input type="checkbox"/>	<input checked="" type="checkbox"/>
g) Subsidence of the land? Discussion: See the discussion under Items III (e) and (f) above. No significant adverse impacts are anticipated.	<input type="checkbox"/>	<input type="checkbox"/>	<input type="checkbox"/>	<input checked="" type="checkbox"/>
h) Expansive soils? Discussion: See the discussion under Items III (e) and (f) above. No significant adverse impacts are anticipated.	<input type="checkbox"/>	<input type="checkbox"/>	<input type="checkbox"/>	<input checked="" type="checkbox"/>
i) Unique geologic or physical features? Discussion: There are no unique geologic or physical features on site.	<input type="checkbox"/>	<input type="checkbox"/>	<input type="checkbox"/>	<input checked="" type="checkbox"/>

IV. WATER. Would the proposal result in:

ISSUES (and Supporting Information Sources):	Potentially Significant Impact	Potentially Significant Unless Mitigation Incorporated	Less Than Significant Impact	No Impact
a) Changes in absorption rates, drainage patterns, or the rate and amount of surface runoff? (Source: 9) Discussion: Not applicable to this project.	<input type="checkbox"/>	<input type="checkbox"/>	<input type="checkbox"/>	<input checked="" type="checkbox"/>
b) Exposure of people or property to water related hazards such as flooding? (Source: 9) Discussion: Not applicable to this project.	<input type="checkbox"/>	<input type="checkbox"/>	<input type="checkbox"/>	<input checked="" type="checkbox"/>
c) Discharge into surface waters or other alteration of surface water quality (e.g. temperature, dissolved oxygen, turbidity)? Discussion: The contract documents for the NWP project include mitigation measures (Storm Water Pollution Prevention Plan) that would mitigate any such impacts..	<input type="checkbox"/>	<input type="checkbox"/>	<input type="checkbox"/>	<input checked="" type="checkbox"/>
d) Changes in the amount of surface water in any water body? Discussion: Not applicable to this project.	<input type="checkbox"/>	<input type="checkbox"/>	<input type="checkbox"/>	<input checked="" type="checkbox"/>
e) Changes in currents, or the course or direction of water movement? Discussion: Not applicable to this project.	<input type="checkbox"/>	<input type="checkbox"/>	<input type="checkbox"/>	<input checked="" type="checkbox"/>
f) Change in the quantity of ground waters, either through direct additions or withdrawals, or through interception of an aquifer by cuts or excavations or through substantial loss of groundwater recharge capability? (Source: 9) Discussion: Not applicable to this project.	<input type="checkbox"/>	<input type="checkbox"/>	<input type="checkbox"/>	<input checked="" type="checkbox"/>
g) Altered direction or rate of flow of groundwater? Discussion: See response to Item #IV.c, above.	<input type="checkbox"/>	<input type="checkbox"/>	<input type="checkbox"/>	<input checked="" type="checkbox"/>
h) Impacts to groundwater quality? Discussion: See response to Item #IV.c, above.	<input type="checkbox"/>	<input type="checkbox"/>	<input type="checkbox"/>	<input checked="" type="checkbox"/>
i) Substantial reduction in the amount of groundwater otherwise available for public water supplies? Discussion: The Reclaimed Water Line will help reduce withdrawals of groundwater for irrigation purposes.	<input type="checkbox"/>	<input type="checkbox"/>	<input type="checkbox"/>	<input checked="" type="checkbox"/>

V. AIR QUALITY. Would the proposal:

ISSUES (and Supporting Information Sources):	Potentially Significant Impact	Potentially Significant Unless Mitigation Incorporated	Less Than Significant Impact	No Impact
a) Violate any air quality standard or contribute to an existing or projected air quality violation? (Source: 10)	<input type="checkbox"/>	<input checked="" type="checkbox"/>	<input type="checkbox"/>	<input type="checkbox"/>
Discussion: Construction phase air quality impacts were identified in the NWP EIR and will be mitigated as a condition of the construction contract.				
b) Expose sensitive receptors to pollutants? (Source: 10)	<input type="checkbox"/>	<input checked="" type="checkbox"/>	<input type="checkbox"/>	<input type="checkbox"/>
Discussion: See response to Item #V.a, above.				
c) Alter air movement, moisture, or temperature? (Source: 10)	<input type="checkbox"/>	<input type="checkbox"/>	<input type="checkbox"/>	<input checked="" type="checkbox"/>
Discussion: Not applicable to this project.				
d) Create objectionable odors? (Source: 10)	<input type="checkbox"/>	<input type="checkbox"/>	<input type="checkbox"/>	<input checked="" type="checkbox"/>
Discussion: Not applicable to this project.				

VI. TRANSPORTATION/CIRCULATION. Would the proposal result in:

a) Increased vehicle trips or traffic congestion?	<input type="checkbox"/>	<input type="checkbox"/>	<input type="checkbox"/>	<input checked="" type="checkbox"/>
Discussion: The project will not generate traffic (other than the temporary use of construction equipment).				
b) Hazards to safety from design features (e.g., sharp curves or dangerous intersections) or incompatible uses (e.g., farm equipment)?	<input type="checkbox"/>	<input type="checkbox"/>	<input type="checkbox"/>	<input checked="" type="checkbox"/>
Discussion: Segments of River Road will be closed to through traffic during construction. The contractor will be required to implement a detour plan.				
c) Inadequate emergency access or inadequate access to nearby uses?	<input type="checkbox"/>	<input type="checkbox"/>	<input type="checkbox"/>	<input checked="" type="checkbox"/>
Discussion: See response to Item #VI.b, above.				
d) Insufficient parking capacity on-site or off-site?	<input type="checkbox"/>	<input type="checkbox"/>	<input type="checkbox"/>	<input checked="" type="checkbox"/>
Discussion: Not applicable to this project.				
e) Hazards or barriers for pedestrians or bicyclists?	<input type="checkbox"/>	<input type="checkbox"/>	<input type="checkbox"/>	<input checked="" type="checkbox"/>
Discussion: See response to Item #VI.b, above.				
f) Conflicts with adopted policies supporting alternative	<input type="checkbox"/>	<input type="checkbox"/>	<input type="checkbox"/>	<input checked="" type="checkbox"/>

ISSUES (and Supporting Information Sources):	Potentially Significant Impact	Potentially Significant Unless Mitigation Incorporated	Less Than Significant Impact	No Impact
transportation (e.g., bus turnouts, bicycle racks)? Discussion: Not applicable to this project.				
g) Rail, waterborne or air traffic impacts? Discussion: Not applicable to this project.	<input type="checkbox"/>	<input type="checkbox"/>	<input type="checkbox"/>	<input checked="" type="checkbox"/>

VII. BIOLOGICAL RESOURCES. Would the proposal result in impacts to:

- a) Endangered, threatened or rare species or their habitats (including but not limited to: plants, fish, insects, animals, and birds)?
- | | | | | |
|--|--------------------------|--------------------------|--------------------------|-------------------------------------|
| | <input type="checkbox"/> | <input type="checkbox"/> | <input type="checkbox"/> | <input checked="" type="checkbox"/> |
|--|--------------------------|--------------------------|--------------------------|-------------------------------------|

Discussion: The sewer and reclaimed water lines are/will be located within the paved area of River Road. Equipment will and materials will be staged in the same locations specified for the NWP Project, which will be selected and regulated to minimize impacts to biological resources in the manner set forth in the NWP EIR.

- b) Locally designated species (e.g., heritage trees)?
- | | | | | |
|--|--------------------------|--------------------------|--------------------------|-------------------------------------|
| | <input type="checkbox"/> | <input type="checkbox"/> | <input type="checkbox"/> | <input checked="" type="checkbox"/> |
|--|--------------------------|--------------------------|--------------------------|-------------------------------------|

Discussion: See response to Item #VII.a, above.

- c) Locally designated natural communities (e.g., oak forest, coastal habitat, etc.)?
- | | | | | |
|--|--------------------------|--------------------------|--------------------------|-------------------------------------|
| | <input type="checkbox"/> | <input type="checkbox"/> | <input type="checkbox"/> | <input checked="" type="checkbox"/> |
|--|--------------------------|--------------------------|--------------------------|-------------------------------------|

Discussion: See response to Item VII.a, above.

- d) Wetland habitat (e.g., marsh, riparian and vernal pool)?
- | | | | | |
|--|--------------------------|--------------------------|--------------------------|-------------------------------------|
| | <input type="checkbox"/> | <input type="checkbox"/> | <input type="checkbox"/> | <input checked="" type="checkbox"/> |
|--|--------------------------|--------------------------|--------------------------|-------------------------------------|

Discussion: See response to Item VII.a, above.

- e) Wildlife dispersal or migration corridors?
- | | | | | |
|--|--------------------------|--------------------------|--------------------------|-------------------------------------|
| | <input type="checkbox"/> | <input type="checkbox"/> | <input type="checkbox"/> | <input checked="" type="checkbox"/> |
|--|--------------------------|--------------------------|--------------------------|-------------------------------------|

Discussion: See response to Item VII.a, above.

VIII. ENERGY AND MINERAL RESOURCES. Would the proposal:

- a) Conflict with adopted energy conservation plans? (Source: 1)
- | | | | | |
|--|--------------------------|--------------------------|--------------------------|-------------------------------------|
| | <input type="checkbox"/> | <input type="checkbox"/> | <input type="checkbox"/> | <input checked="" type="checkbox"/> |
|--|--------------------------|--------------------------|--------------------------|-------------------------------------|

Discussion: Not applicable to this project.

- b) Use non-renewable resource in a wasteful and inefficient manner? (Source: 1)
- | | | | | |
|--|--------------------------|--------------------------|--------------------------|-------------------------------------|
| | <input type="checkbox"/> | <input type="checkbox"/> | <input type="checkbox"/> | <input checked="" type="checkbox"/> |
|--|--------------------------|--------------------------|--------------------------|-------------------------------------|

Discussion: Not applicable to this project.

- c) Result in the loss of availability of a known mineral resource

ISSUES (and Supporting Information Sources):	Potentially Significant Impact	Potentially Significant Unless Mitigation Incorporated	Less Than Significant Impact	No Impact
that would be of future value to the region and the residents of the State? (Source: 1)	<input type="checkbox"/>	<input type="checkbox"/>	<input type="checkbox"/>	<input checked="" type="checkbox"/>

Discussion: Not applicable to this project.

IX. HAZARDS. Would the proposal involve:

a) A risk of accidental explosion or release of hazardous substances (including, but not limited to: oil, pesticides, chemicals or radiation)?	<input type="checkbox"/>	<input checked="" type="checkbox"/>	<input type="checkbox"/>	<input type="checkbox"/>
--	--------------------------	-------------------------------------	--------------------------	--------------------------

Discussion: During sewer bypass operations, the contractor will be required to implement a “bypass pumping plan”, specifications for which will be established in the contract documents. This plan will set forth conditions for installing and operating the bypass in a manner that prevents spills and provides measures for mitigating any spills that might occur.

b) Possible interference with an emergency response plan or emergency evacuation plan?	<input type="checkbox"/>	<input type="checkbox"/>	<input type="checkbox"/>	<input checked="" type="checkbox"/>
--	--------------------------	--------------------------	--------------------------	-------------------------------------

Discussion: Not applicable to this project.

c) The creation of any health hazard or potential hazards?	<input type="checkbox"/>	<input type="checkbox"/>	<input type="checkbox"/>	<input checked="" type="checkbox"/>
--	--------------------------	--------------------------	--------------------------	-------------------------------------

Discussion: See response to Item IX.a, above.

d) Increased fire hazard in areas with flammable brush, grass, or trees?	<input type="checkbox"/>	<input type="checkbox"/>	<input type="checkbox"/>	<input checked="" type="checkbox"/>
--	--------------------------	--------------------------	--------------------------	-------------------------------------

Discussion:

X. NOISE. Would the proposal result in:

a) Increases in existing noise levels?	<input type="checkbox"/>	<input type="checkbox"/>	<input type="checkbox"/>	<input checked="" type="checkbox"/>
--	--------------------------	--------------------------	--------------------------	-------------------------------------

Discussion: The contract documents specify that construction shall be limited to the hours of 7:00 am to 7:00 pm, which is in conformance with the City’s noise regulations (Paso Robles Municipal Code Chapter 9.07).

b) Exposure of people to severe noise levels?	<input type="checkbox"/>	<input type="checkbox"/>	<input type="checkbox"/>	<input checked="" type="checkbox"/>
---	--------------------------	--------------------------	--------------------------	-------------------------------------

Discussion: See response to Item X.a, above.

XI. PUBLIC SERVICES. Would the proposal have an effect upon, or result in a need for new or altered government services in any of the following areas:

a) Fire protection? (Source: 1,9)	<input type="checkbox"/>	<input type="checkbox"/>	<input type="checkbox"/>	<input checked="" type="checkbox"/>
-----------------------------------	--------------------------	--------------------------	--------------------------	-------------------------------------

Discussion: Not applicable to this project.

b) Police Protection? (Source: 1,9)	<input type="checkbox"/>	<input type="checkbox"/>	<input type="checkbox"/>	<input checked="" type="checkbox"/>
-------------------------------------	--------------------------	--------------------------	--------------------------	-------------------------------------

ISSUES (and Supporting Information Sources):	Potentially Significant Impact	Potentially Significant Unless Mitigation Incorporated	Less Than Significant Impact	No Impact
Discussion: Not applicable to this project.				
c) Schools?	<input type="checkbox"/>	<input type="checkbox"/>	<input type="checkbox"/>	<input checked="" type="checkbox"/>
Discussion: Not applicable to this project.				
d) Maintenance of public facilities, including roads?	<input type="checkbox"/>	<input type="checkbox"/>	<input type="checkbox"/>	<input checked="" type="checkbox"/>
Discussion: Not applicable to this project.				
e) Other governmental services? (Source: 1,9)	<input type="checkbox"/>	<input type="checkbox"/>	<input type="checkbox"/>	<input checked="" type="checkbox"/>
Discussion: Not applicable to this project.				

XII. UTILITIES AND SERVICE SYSTEMS.

Would the proposal result in a need for new systems or supplies, or substantial alterations to the following utilities:

a) Power or natural gas?	<input type="checkbox"/>	<input type="checkbox"/>	<input type="checkbox"/>	<input checked="" type="checkbox"/>
Discussion: Not applicable to this project.				
b) Communication systems?	<input type="checkbox"/>	<input type="checkbox"/>	<input type="checkbox"/>	<input checked="" type="checkbox"/>
Discussion: Not applicable to this project.				
c) Local or regional water treatment or distribution facilities? (Source: 1,9)	<input type="checkbox"/>	<input type="checkbox"/>	<input type="checkbox"/>	<input checked="" type="checkbox"/>
Discussion: Not applicable to this project.				
d) Sewer or septic tanks? (Source: 1,9)	<input type="checkbox"/>	<input type="checkbox"/>	<input type="checkbox"/>	<input checked="" type="checkbox"/>
Discussion: The purpose of this project is to implement the 2007 Sewer Collection System Master Plan.				
e) Storm water drainage? (Source: 1,9)	<input type="checkbox"/>	<input type="checkbox"/>	<input type="checkbox"/>	<input checked="" type="checkbox"/>
Discussion: Not applicable to this project.				
f) Solid waste disposal? (Source: 1,9)	<input type="checkbox"/>	<input type="checkbox"/>	<input type="checkbox"/>	<input checked="" type="checkbox"/>
Discussion: Not applicable to this project.				
g) Local or regional water supplies? (Source: 1,9)	<input type="checkbox"/>	<input type="checkbox"/>	<input type="checkbox"/>	<input checked="" type="checkbox"/>

Discussion: The purpose of the Reclaimed Water line is to protect local water supplies, as outlined I the 2007 Integrated Water Resources Plan.

XIII. AESTHETICS. Would the proposal:

ISSUES (and Supporting Information Sources):	Potentially Significant Impact	Potentially Significant Unless Mitigation Incorporated	Less Than Significant Impact	No Impact
a) Affect a scenic vista or scenic highway? Discussion: See response under Item #Ic, above.	<input type="checkbox"/>	<input type="checkbox"/>	<input type="checkbox"/>	<input checked="" type="checkbox"/>
b) Have a demonstrable negative aesthetic effect? Discussion: See response under Item #Ic, above.	<input type="checkbox"/>	<input type="checkbox"/>	<input type="checkbox"/>	<input checked="" type="checkbox"/>
c) Create light or glare? (Source: 1, 2, 9) Discussion: Not applicable to this project.	<input type="checkbox"/>	<input type="checkbox"/>	<input type="checkbox"/>	<input checked="" type="checkbox"/>

XIV.CULTURAL RESOURCES. Would the proposal:

a) Disturb paleontological resources? Discussion: The project will excavate land that has already once been excavated (for the laying of the existing sewer main). There will be no impacts to paleontological or archaeological resources.	<input type="checkbox"/>	<input type="checkbox"/>	<input type="checkbox"/>	<input checked="" type="checkbox"/>
b) Disturb archaeological resources? Discussion: See response under Item #XIV.a, above.	<input type="checkbox"/>	<input type="checkbox"/>	<input type="checkbox"/>	<input checked="" type="checkbox"/>
c) Affect historical resources? Discussion: No historical resources will be affected by the project.	<input type="checkbox"/>	<input type="checkbox"/>	<input type="checkbox"/>	<input checked="" type="checkbox"/>
d) Have the potential to cause a physical change which would affect unique ethnic cultural values? Discussion: Not applicable to this project.	<input type="checkbox"/>	<input type="checkbox"/>	<input type="checkbox"/>	<input checked="" type="checkbox"/>
e) Restrict existing religious or sacred uses within the potential impact area? Discussion: Not applicable to this project.	<input type="checkbox"/>	<input type="checkbox"/>	<input type="checkbox"/>	<input checked="" type="checkbox"/>

XV.RECREATION. Would the proposal:

a) Increase the demand for neighborhood or regional parks or other recreational facilities? Discussion: Not applicable to this project.	<input type="checkbox"/>	<input type="checkbox"/>	<input type="checkbox"/>	<input checked="" type="checkbox"/>
b) Affect existing recreational opportunities?	<input type="checkbox"/>	<input type="checkbox"/>	<input type="checkbox"/>	<input checked="" type="checkbox"/>

ISSUES (and Supporting Information Sources):	Potentially Significant Impact	Potentially Significant Unless Mitigation Incorporated	Less Than Significant Impact	No Impact
--	--------------------------------------	--	------------------------------------	-----------

Discussion: Not applicable to this project.

XVI.MANDATORY FINDINGS OF SIGNIFICANCE.

- | | | | | |
|--|--------------------------|-------------------------------------|--------------------------|--------------------------|
| a) Does the project have the potential to degrade the quality of the environment, substantially reduce the habitat of a fish or wildlife species, cause a fish or wildlife population to drop below self-sustaining levels, threaten to eliminate a plant or animal community, reduce the number or restrict the range of a rare or endangered plant or animal or eliminate important examples of the major periods of California history or prehistory? | <input type="checkbox"/> | <input checked="" type="checkbox"/> | <input type="checkbox"/> | <input type="checkbox"/> |
|--|--------------------------|-------------------------------------|--------------------------|--------------------------|

Discussion: One potentially significant impact that would not have been addressed with the NWP project is prevention of sewage leaks and mitigation of any sewage leaks that might occur during sewer bypass operations, as is noted in Item #IX.a, above. To mitigate such impacts, the contract documents will require the contractor to prepare and implement a “bypass pumping plan”.

- | | | | | |
|---|--------------------------|--------------------------|--------------------------|-------------------------------------|
| b) Does the project have the potential to achieve short-term, to the disadvantage of long-term environmental goals? | <input type="checkbox"/> | <input type="checkbox"/> | <input type="checkbox"/> | <input checked="" type="checkbox"/> |
|---|--------------------------|--------------------------|--------------------------|-------------------------------------|

Discussion: Not applicable to this project.

- | | | | | |
|--|--------------------------|--------------------------|--------------------------|-------------------------------------|
| c) Does the project have impacts that are individually limited, but cumulatively considerable? (“Cumulatively considerable” means that the incremental effects of a project are considerable when viewed in connection with the effects of past projects, the effects of other current projects, and the effects of probable future projects.) | <input type="checkbox"/> | <input type="checkbox"/> | <input type="checkbox"/> | <input checked="" type="checkbox"/> |
|--|--------------------------|--------------------------|--------------------------|-------------------------------------|

Discussion: Not applicable to this project.

- | | | | | |
|---|--------------------------|--------------------------|--------------------------|-------------------------------------|
| d) Does the project have environmental effects which will cause substantial adverse effects on human beings, either directly or indirectly? | <input type="checkbox"/> | <input type="checkbox"/> | <input type="checkbox"/> | <input checked="" type="checkbox"/> |
|---|--------------------------|--------------------------|--------------------------|-------------------------------------|

Discussion: See response to Item #XVI.a, above.

Exhibit A

EARLIER ANALYSIS AND BACKGROUND MATERIALS.

Earlier analyses may be used where, pursuant to tiering, program EIR, or other CEQA process, one or more effects have been adequately analyzed in an earlier EIR or negative declaration. Section 15063 (c)(3)(D).

Earlier Documents Prepared and Utilized in this Analysis and Background / Explanatory Materials

<u>Reference #</u>	<u>Document Title</u>	<u>Available for Review at:</u>
1	City of Paso Robles General Plan	City of Paso Robles Community Development Department 1000 Spring Street Paso Robles, CA 93446
2	City of Paso Robles Zoning Code	Same as above
3	City of Paso Robles Environmental Impact Report for General Plan Update	Same as above
4	2005 Airport Land Use Plan	Same as above
5	City of Paso Robles Municipal Code	Same as above
6	City of Paso Robles Water Master Plan	Same as above
7	City of Paso Robles Sewer Master Plan	Same as above
8	City of Paso Robles Housing Element	Same as above
9	City of Paso Robles Standard Conditions of Approval for New Development	Same as above
10	San Luis Obispo County Air Pollution Control District Guidelines for Impact Thresholds	APCD 3433 Roberto Court San Luis Obispo, CA 93401
11	San Luis Obispo County – Land Use Element	San Luis Obispo County Department of Planning County Government Center San Luis Obispo, CA 93408
12	USDA, Soils Conservation Service, Soil Survey of San Luis Obispo County, Paso Robles Area, 1983	USDA Soil Conservation Offices 65 Main Street, Suite 108 Templeton, CA 93465

Exhibit B

MITIGATION MONITORING PLAN

Mitigation Measure	Time Frame	Monitoring Agency
<u>Hazards:</u> The contract documents for the Change Order to add the Templeton Interceptor Upgrade and Reclaimed Water to the Nacimiento Water Project shall include a requirement, complete with detailed specifications, that the contractor prepared and implement a “bypass pumping plan” to set forth conditions for installing and operating the bypass in a manner that prevents spills and provides measures for mitigating any spills that might occur.	Prior to approval of a Change Order to add the Templeton Interceptor Upgrade and Reclaimed Water to the Nacimiento Water Project	Community Development and Public Works Departments

PROOF OF PUBLICATION

LEGAL NEWSPAPER NOTICES

PLANNING COMMISSION/CITY COUNCIL
PROJECT NOTICING

Newspaper: Tribune

Date of Publication: September 12, 2007

Meeting Date: October 2, 2007
(City Council)

Project: Templeton Interceptor (Sewer Main) Upgrade and Reclaimed Water Line in River Road

I, Lonnie Dolan, employee of the Community Development Department, Planning Division, of the City of El Paso de Robles, do hereby certify that this notice is a true copy of a published legal newspaper notice for the above named project.

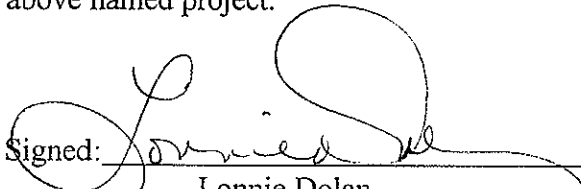
Signed: 
Lonnie Dolan

forms/newsaffi.691

NOTICE OF INTENT TO ADOPT A NEGATIVE DECLARATION

NOTICE IS HEREBY GIVEN that the City Council of the City of El Paso de Robles will consider adoption of a Mitigated Negative Declaration (statement that there will be no significant environmental effects if one or more mitigation measures are incorporated into the project) in accordance with the provisions of the California Environmental Quality Act (CEQA) for the following project:

Templeton Interceptor (Sewer Main) Upgrade and Reclaimed Water Line in River Road. This project is initiated by the City of Paso Robles pursuant to the 2007 Sewer Collection System Master Plan, 2007 Integrated Water Resources Plan, and the 2003 General Plan. The City has initiated the work described below to consist of the following components:

A. Upgrade the existing Templeton Interceptor sewer main in River Road in two reaches (sections) from 21 and 24 inch VCP pipe to 27 to 30 inch VCP or PVC pipe. The two reaches are as follows:

Reach 1: Beginning at Lift Station #1, which is located approximately 1,600 feet north of River Oaks Drive, extending south to Union Road.

Reach 2: Beginning at a point approximately 400 feet south of Creston Road, extending south to Navajo Avenue.

B. Install a reclaimed water line in River Road between Lift Station #1 on the north and the Highway 46E overpass on the south.

The City Council will consider adoption of a Mitigated Negative Declaration at a public meeting to be conducted Tuesday, October 2, 2007, which will take place at the hour of 7:30 pm in the Conference Center (First Floor) at the Paso Robles Library/City Hall, 1000 Spring Street, Paso Robles, California. All interested parties may appear and be heard at this hearing.

Copies of the draft Mitigated Negative Declaration are available at the Community Development Department, City Hall, 1000 Spring Street, Paso Robles, CA 93446 effective September 12, 2007. The Mitigated Negative Declaration comment period will extend from September 12, 2007 through October 2, 2007. Please write to this address or call contact Ed Gallagher at (805) 237-3970 or via email at ed@prcity.com should you have questions or comments regarding this notice or related matters.

If you challenge the action of the City Council in court, you may be limited to raising only those issues you or someone else raised at the public meeting described in this notice, or in written correspondence delivered to the City Council at, or prior to, the public meeting described herein.

Ed Gallagher, City Planner
September 12, 2007 6634721